

# TEMPERATURE SENSOR

## T-115

### Applications:

Temperature sensor for indoor use.

### Technical Data

Measuring range	up to 70°C
Resistance element:	Pt100 up to PN-EN 60751+A2 Pt1000, Pt500
Protection box material	polycarbonate
Connection line	2, 3 or 4 wire
Protection box ambient temperature	-30°C do 100°C
With transmitter	P - table of transmitters



### Ordering code

	-	T	-	115	-		-		-	
Transmitter		up to table e.g. P1								
Tolerance class - A, B		e.g. B								
Connection line		2-wire, 3-wire, 4-wire e.g. 2								
Measuring insert		Pt100, 2xPt100, others e.g. Pt100								

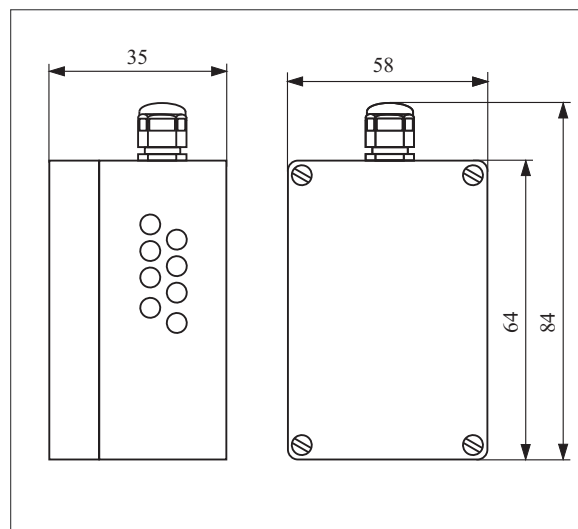

### Order example:

T-115-B-2-Pt100 - class B, 2-wire, Pt100.